

TERMINAL Prensado Macho Fixo BSP NORMA BS 5200

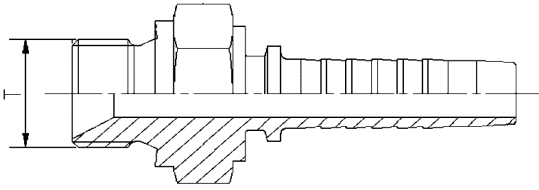

Terminal reto macho fixo BSP, vedação assento 60°, ou na base da rosca com junta de cobre.
Material: Aço carbono bicromatizado.

Ø		Rosca	Código Novo	Código Antigo
Pol.	Bitola			
1/4"	-4	1/4"-19	XX020101X-04-04	100MB-04-04
1/4"	-4	3/8"-19	XX020101X-06-04	100MB-06-04
5/16"	-5	3/8"-19	XX020101X-06-05	100MB-06-05
3/8"	-6	3/8"-19	XX020101X-06-06	100MB-06-06
3/8"	-6	1/2"-14	XX020101X-08-06	100MB-08-06
1/2"	-8	3/8"-19	XX020101X-06-08	100MB-06-08
1/2"	-8	1/2"-14	XX020101X-08-08	100MB-08-08
1/2"	-8	3/4"-14	XX020101X-12-08	100MB-12-08
5/8"	-10	3/4"-14	XX020101X-12-10	100MB-12-10
3/4"	-12	3/4"-14	XX020101X-12-12	100MB-12-12
3/4"	-12	1"-11	XX020101X-16-12	100MB-16-12
1"	-16	1"-11	XX020101X-16-16	100MB-16-16
1"	-16	1.1/4"-11	XX020101X-20-16	100MB-20-16
1.1/4"	-20	1.1/4"-11	XX020101X-20-20	100MB-20-20
1.1/2"	-24	1.1/2"-11	XX020101X-24-24	100MB-24-24
2"	-32	2"-11	XX020101X-32-32	100MB-32-32

Este código refere-se somente ao pino, sem a capa

TERMINAL Prensado Reto Fêmea Giratória BSP Boleado - Norma BS5200

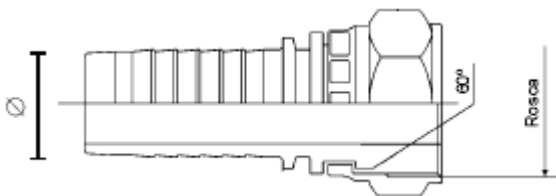

Terminal reto fêmea giratória
rosca BSP vedação boleada
com assento 60°.
Material: Aço carbono
bicromatizado.

Ø		Rosca	Código Novo	Código Antigo
Pol.	Bitola			
1/4"	-4	1/8"-28	XX020401X-02-04	100FB-02-04
1/4"	-4	1/4"-19	XX020401X-04-04	100FB-04-04
1/4"	-4	3/8"-19	XX020401X-06-04	100FB-06-04
5/16"	-5	1/4"-19	XX020401X-04-05	100FB-04-05
5/16"	-5	3/8"-19	XX020401X-06-05	100FB-06-05
3/8"	-6	1/4"-19	XX020401X-04-06	100FB-04-06
3/8"	-6	3/8"-19	XX020401X-06-06	100FB-06-06
3/8"	-6	1/2"-14	XX020401X-08-06	100FB-08-06
1/2"	-8	3/8"-19	XX020401X-06-08	100FB-06-08
1/2"	-8	1/2"-14	XX020401X-08-08	100FB-08-08
1/2"	-8	3/4"-14	XX020401X-12-08	100FB-12-08
5/8"	-10	3/4"-14	XX020401X-12-10	100FB-12-10
3/4"	-12	3/4"-14	XX020401X-12-12	100FB-12-12
3/4"	-12	1"-11	XX020401X-16-12	100FB-16-12
1"	-16	1"-11	XX020401X-16-16	100FB-16-16
1"	-20	1.1/4"-11	XX020401X-20-16	100FB-20-16
1.1/4"	-20	1.1/4"-11	XX020401X-20-20	100FB-20-20
1.1/4"	-20	1.1/2"-11	XX020401X-24-20	100FB-24-20
1.1/2"	-24	1.1/2"-11	XX020401X-24-24	100FB-24-24
2"	-32	2"-11	XX020401X-32-32	100FB-32-32

Este código refere-se somente ao pino, sem a capa

TERMINAL Prensado 45° Fêmea Giratória BSP Boleado - Norma BS5200

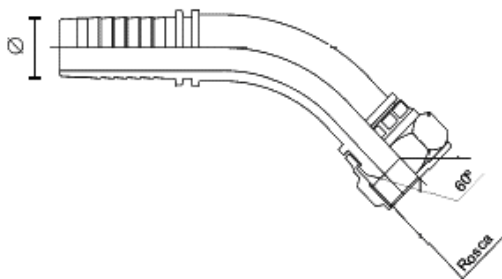

Terminal 45° fêmea giratória rosca BSP vedação boleada com assento 60°.

Material: Aço carbono bicromatizado

Ø		Rosca	Código Novo	Código Antigo
Pol.	Bitola			
1/4"	-4	1/8"-28	XX024401X-02-04	145FB-02-04
1/4"	-4	1/4"-19	XX024401X-04-04	145FB-04-04
1/4"	-4	3/8"-19	XX024401X-06-04	145FB-06-04
5/16"	-5	3/8"-19	XX024401X-06-05	145FB-06-05
3/8"	-6	3/8"-19	XX024401X-06-06	145FB-06-06
3/8"	-6	1/2"-14	XX024401X-08-06	145FB-08-06
1/2"	-8	1/2"-14	XX024401X-08-08	145FB-08-08
1/2"	-8	3/4"-14	XX024401X-12-08	145FB-12-08
5/8"	-10	3/4"-14	XX024401X-12-10	145FB-12-10
3/4"	-12	3/4"-14	XX024401X-12-12	145FB-12-12
3/4"	-12	1"-11	XX024401X-16-12	145FB-16-12
1"	-16	1"-11	XX024401X-16-16	145FB-16-16
1.1/4"	-20	1.1/4"-11	XX024401X-20-20	145FB-20-20
1.1/2"	-24	1.1/2"-11	XX024401X-24-24	145FB-24-24
2"	-32	2"-11	XX024401X-32-32	145FB-32-32

Este código refere-se somente ao pino, sem a capa

TERMINAL Prensado 90° Fêmea Giratória BSP Boleado - Norma BS5200

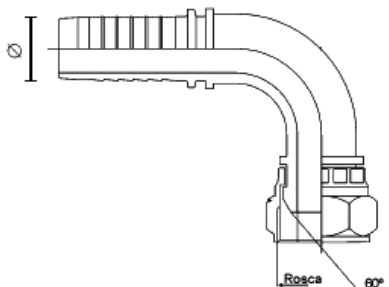

Terminal 90° fêmea giratória rosca BSP
vedação boleada com assento 60°.
Material: Aço carbono bicromatizado

Ø		Rosca	Código Novo	Código Antigo
Pol.	Bitola			
1/4"	-4	1/8"-28	XX029401X-02-04	190FB-02-04
1/4"	-4	1/4"-19	XX029401X-04-04	190FB-04-04
1/4"	-4	3/8"-19	XX029401X-06-04	190FB-06-04
5/16"	-5	3/8"-19	XX029401X-06-05	190FB-06-05
3/8"	-6	3/8"-19	XX029401X-06-06	190FB-06-06
3/8"	-6	1/2"-14	XX029401X-08-06	190FB-08-06
1/2"	-8	1/2"-14	XX029401X-08-08	190FB-08-08
1/2"	-8	3/4"-14	XX029401X-12-08	190FB-12-08
5/8"	-10	1/2"-14	XX029401X-08-10	190FB-08-10
5/8"	-10	3/4"-14	XX029401X-12-10	190FB-12-10
3/4"	-12	3/4"-14	XX029401X-12-12	190FB-12-12
3/4"	-12	1"-11	XX029401X-16-12	190FB-16-12
1"	-16	1"-11	XX029401X-16-16	190FB-16-16
1"	-16	1.1/4"-11	XX029401X-20-16	190FB-20-16
1.1/4"	-20	1.1/4"-11	XX029401X-20-20	190FB-20-20
1.1/4"	-20	1.1/2"-11	XX029401X-24-20	190FB-24-20
1.1/2"	-24	1.1/2"-11	XX029401X-24-24	190FB-24-24
2"	-32	2"-11	XX029401X-32-32	190FB-32-32

Este código refere-se somente ao pino, sem a capa